

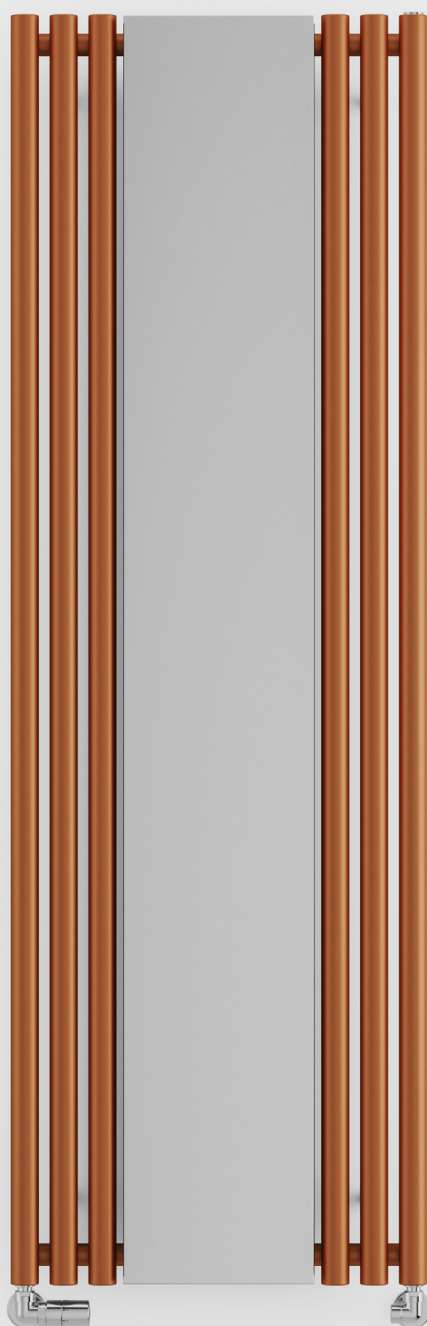

TERMA

SINCE 1990



◀ **Radiator**

ROLO MIRROR 1800↕ x 590↔ SX,
radiator colour: True Copper,
radiator code: WGROM180059 KTCGSX

Valves and accessories

3-axis regulating valve set, chrome

ROLO MIRROR



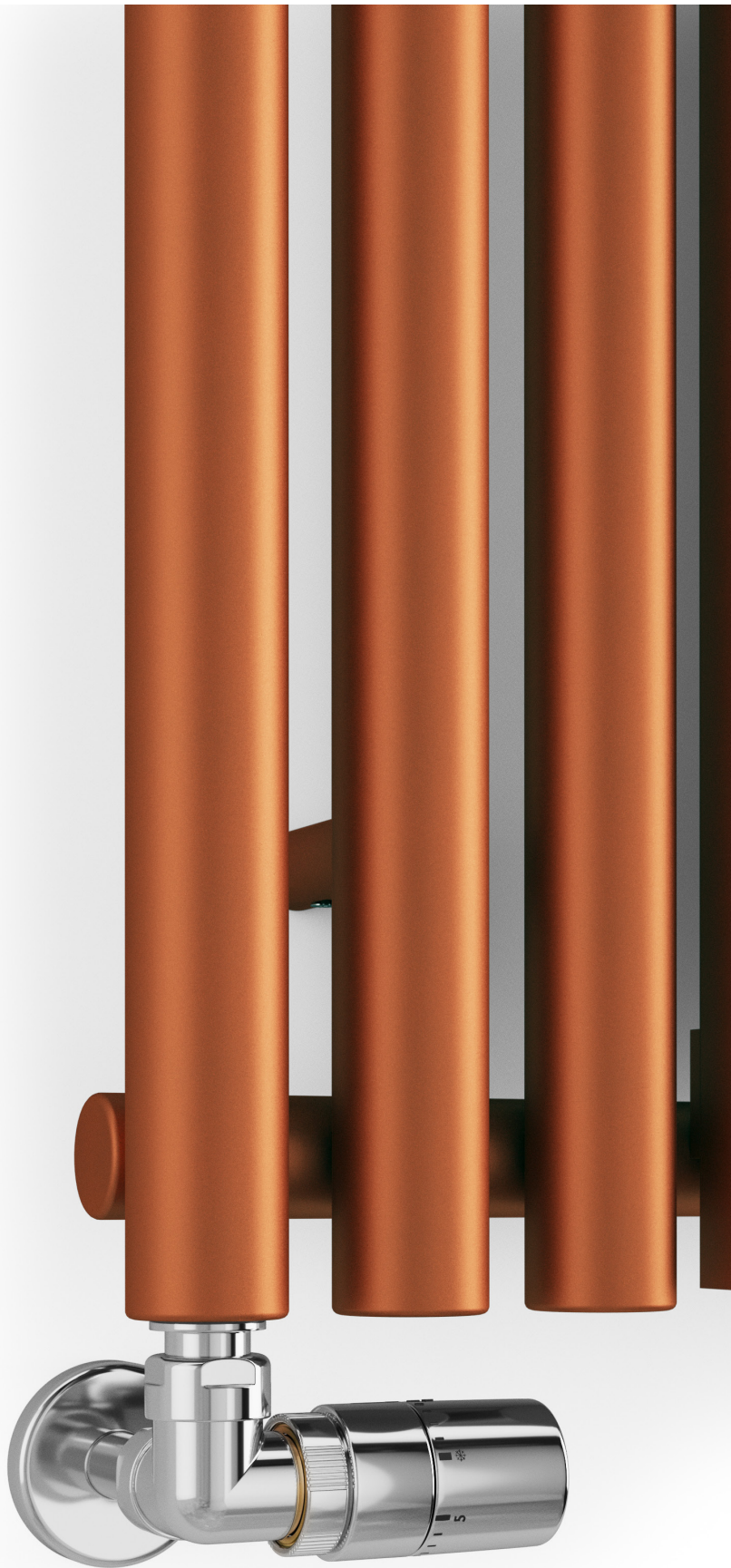

AVAILABLE SIZES

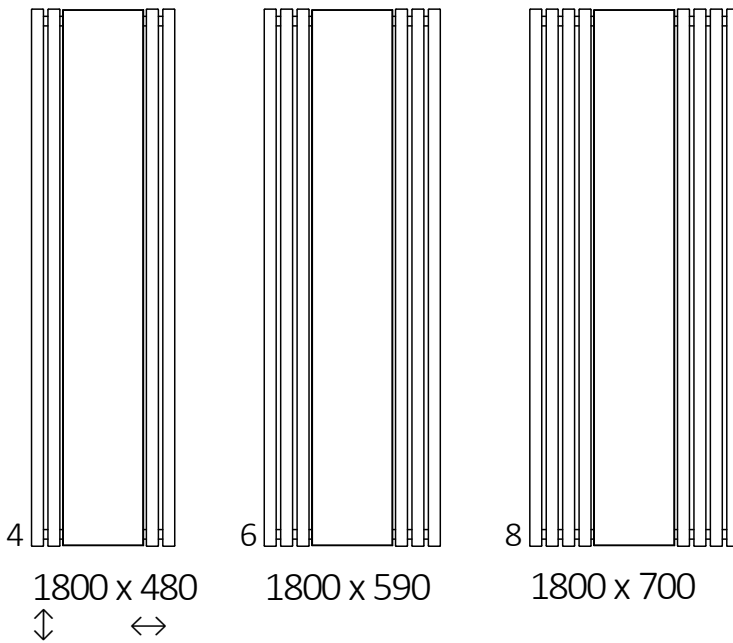

CENTRAL HEATING

Connections



Height A ↕ [mm]	Width B ↔ [mm]	Heating power			Product code ... Configuration p.5
		75/65/20°C [W]	55/45/20°C [W]	[W]	
1800	480	611	320	600	WGROM180048
1800	590	837	428	800	WGROM180059
1800	700	1058	538	1000	WGROM180070

DIMENSIONS AND TECHNICAL INFORMATION

Working pressure: 1000 kPa

Maximum operating temperature: 95°C

Height A ↕ [mm]	Width B ↔ [mm]	Spacing connection C2 [mm]	Spacing connection C3 [mm]	Spacing connection C4 [mm]	Spacing connection C5 [mm]	Spacing horizontal fasteners D [mm]	Spacing vertical fasteners E [mm]	Bottom fasteners position F [mm]	Capacity [dm³]	Weight [kg]
1800	480	440	1720	480	500	440	1560	120	8,40	18.30
1800	590	550	1720	590	500	550	1560	120	12,42	23,89
1800	700	660	1720	700	500	660	1560	120	16,45	29,48

TECHNICAL DRAWING

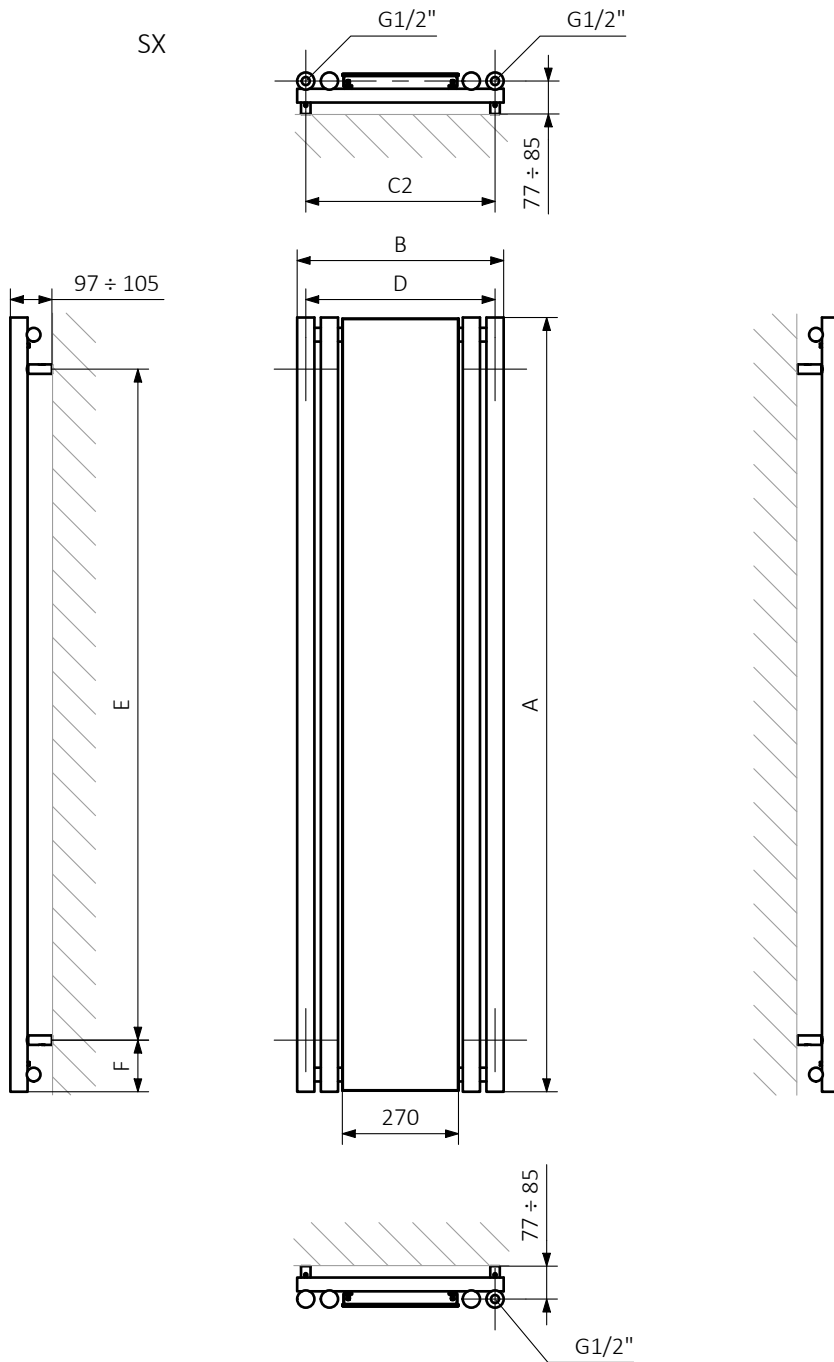

A – Height B – Width C1-C5 – Distance between pipe centres D – Horizontal distance between mounting bracket centres E – Vertical distance between mounting brackets F – Distance between a mounting bracket and the bottom of the radiator

Collector:

Pipe:

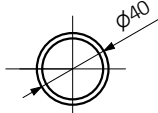
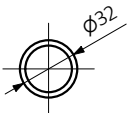

CONFIGURATION CODE FOR A TOWEL RAIL OR RADIATOR ("WG" PRODUCT GROUP)

Product codes can be found in the product tables in both the catalogue and the price list. They provide basic information about the product and the configuration code contains information that complements the specification. When placing an order, the product codes should contain the fully completed configuration part. Part of the configuration code should be placed after the main product code as shown in the example below:

CODE DETAILS:

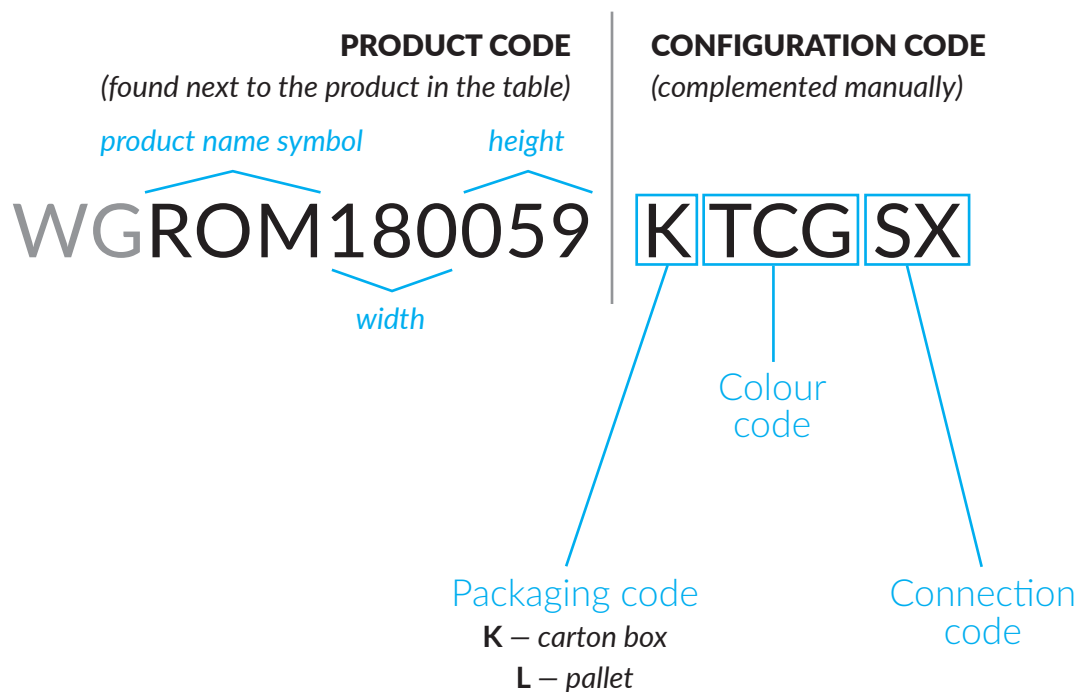

WG – water or dual fuel, central heating towel rail or radiator