

USER'S MANUAL

3-axis regulating valve set

VISION ALL IN ONE

VISION ALL IN ONE – 3- AXIS REGULATING VALVE SET

The set contains:

- 3-axis regulating valve
- 3-axis lockshield valve
- Pipe-masking set
- 2 × adapter PEX, ALU-PEX 16×2
- 2 × adapter CU Ø 15

The valve should be installed in accordance with the specified direction of the heating medium supply and return.

A product of the Polish Vario Term brand. Available from stock in the following colours:

- white (RAL 9016)
- soft white (SOFT 9016)
- black (RAL 9005)
- matte black (MAT 9005)
- chrome

On request, the set is available in all single-coating colours from the Terma palette, i.e. in all RAL colours and in most special colours, as well as in colours: Soft 9005, Soft 7047, Mat 7016

The set is not available in the RAL colours in SOFT and MAT finishes and in special colours: Black Crocodile New, White Gold.

The set is not available in the Premium palette colours (liquid paints)

Available connections:



Distributor: Terma Sp. z o.o. | Czaple 100 | 80-298 Gdańsk | termagroup.pl
Manufacturer: Vario Term Sp. z o.o. | ul. Ogórkowa 96 | 04-998 Warsaw

TECHNICAL DATA

Operating temperature	120°C
Nominal pressure	1MPa
Heating medium	water
Test pressure	1.5 MPa
Initial setting	on lockshield valve
Radiator connection	G 1/2

Flow diagram for VISION manual knob and lockshield valve

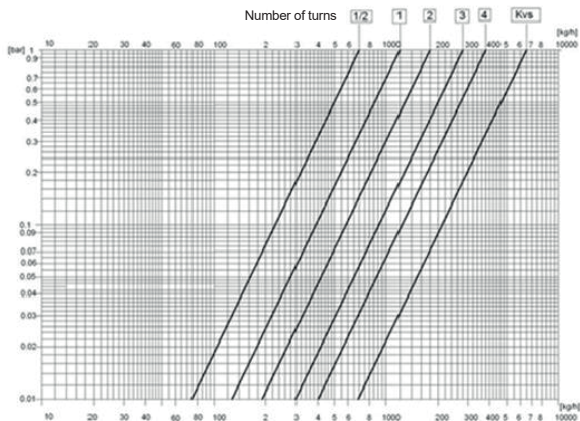

Kv value for a given number of turns of the lockshield valve insert / adjustment knob

Number of turns in the valve opening direction	1/2	1	2	3	4	Kvs
Kv	0,07	0,10	0,18	0,30	0,38	0,65

CORRECT ASSEMBLY OF THE VISION CONNECTION TO THE INSTALLATION

Assembly and setting details available at www.varioterm.pl

– **LEFT** version
Max. torque 3Nm when tightening

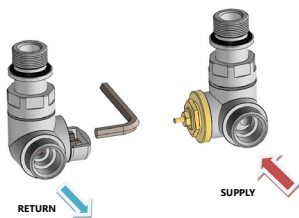

– **RIGHT** version
Max. torque 3Nm when tightening

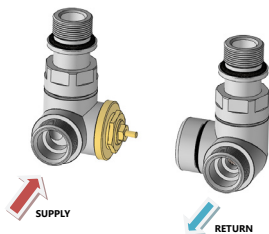

DETAILED ASSEMBLY INSTRUCTIONS

Set catalogue number: **VIR..L – left*** | **VIR..P – right**

1

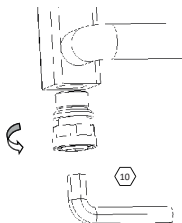

Warning:

When tightening, make sure not to damage the O-ring responsible for tightness between the radiator and the coupling.

2.a (PEX 16x2)

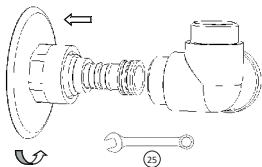

Warning:

When mounting the 16x2 coupling, make sure not to damage the O-rings providing coupling tightness between the installation and the valve.

3

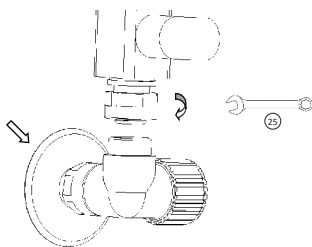

4

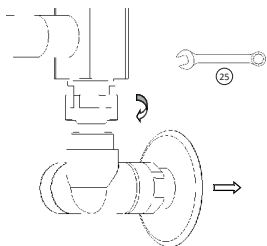

5

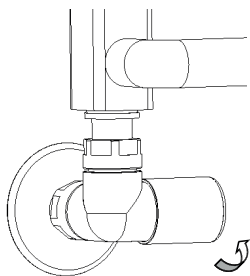

Warning:
Flow adjustment in
accordance with the
Product Data Sheet
(www.varioterm.pl).

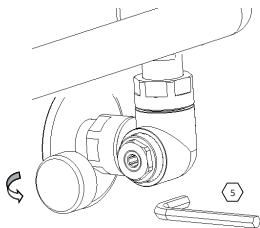
**Warning:**

Flow adjustment in accordance with the Product Data Sheet.

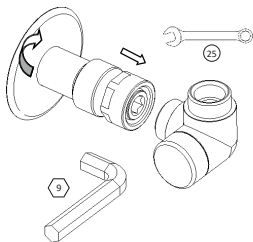
2.b (RP 1/2)**Warning:**

I. Seal the threaded connection and then screw in the coupling with a hex key.

II. Insert the coupling onto the valve body and tighten it with a 25 mm wrench.

2.c (Cu 15x1)

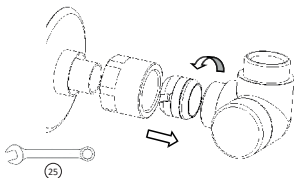

Warning:

Remove any sharp material residue from the outside of the 15x1 tube that may damage the rubber gasket of the coupling when pushing it onto the tube. After tightening the coupling **with a torque of 15 Nm**, first make sure that the tube cannot be rotated and/or removed by pulling it **STRONGLY**, and then proceed to check for any hydraulic leaks. Maintain a 90° angle between the tube and the radiator.

WARRANTY TERMS

1. The manufacturer provides a warranty for a period of 3 years from the date of purchase.
2. Defects revealed during the warranty period will be removed free of charge within 14 business days from the date of their notification.
3. A defect or damage must be notified by email at **reklamacje@varioterm.pl** or by phone at (022) 8724214.
4. To perform a warranty repair, the defective product must be delivered to the VARIO TERM office with a description of the reason for the complaint and a copy of the proof of purchase with the stamp of the facility where the purchase was made and clearly marked with the date of purchase.
5. The warranty does not cover parts that are subject to natural wear and tear during the period of use, defects caused by
6. assembly and use inconsistent with the instructions, defects with traces of mechanical damage, thermal damage or traces of user manipulation.
7. The purchaser loses all rights under the warranty in the event of:
 - loss or destruction of the proof of purchase,
 - unauthorised repairs, disassembly,
 - use that is improper or inconsistent with the manual.